

# EXCELLENT EDITION 650 UMFE

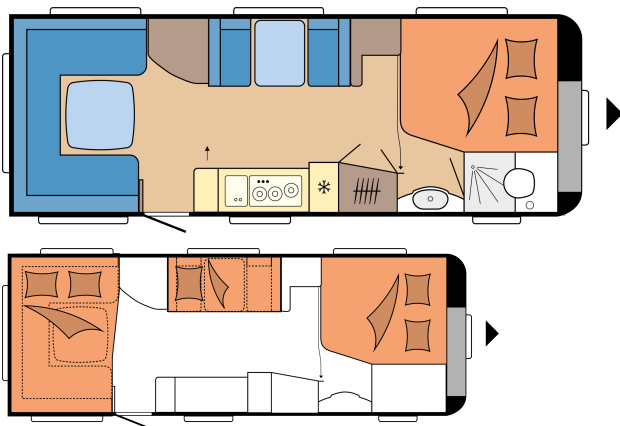

## FLOORPLAN



Overall length	8.325 mm
Total width	2.500 mm
Technically permissible gross weight	1.900 kg

from: 0 £

Note: The vehicles shown are model examples. Illustrations may vary.

## TECHNICAL DATA

Model	650 UMFe	Awning circumference	10.920 mm
Number of axles	2	Beading (straight edge)	5.172
Tyre size	155 / 80 R 13 XL	Number of berths (adults / children)	4 / 1
Overall length	8.325 mm	Bed size, double bed (length x width)	1.950 x 1.570 / 1.280 mm
Body length	7.156 mm	Bed size, seating area bed conversion (length x width)	2.233 x 1.450; 1.800 x 835 mm
Overall width / Inside width	2.500 / 2.367 mm	Autonomy package	Front centre
Overall height / Interior headroom	2.629 / 1.950 mm	Roof-mounted air conditioning unit	Centre
Maximum technically permissible laden mass	1.900 kg	TV bracket	Sideboard
Mass in running order	1.647 kg	Fresh water tank; city water connection, optional	Rear right
Payload	253 kg	External gas socket	Rear right
Technically possible increase in load capacity to	2.200 kg	Exterior awning socket	Rear right
Payload after maximum increase in load capacity	545 kg	Locker door MAXI, THETFORD with central locking, 1,000 x 300 mm, lockable	Front left
Technically possible decrease in load capacity to	1.800 kg	Number of 230 V power sockets (single / double)	5 / 3
Body wall thickness (floor / roof / wall)	39 / 31 / 31 mm		

## HOBBYKOMPLETT

Chassis / Safety: Jockey wheel, Drawbar cover, One-key locking system, Integrated 3rd brake light, Rear fog light, Wheel shock absorbers, Heavy-duty supports, Licensed for up to 100 kph, Stabiliser hitch KNOTT, Overrun brake KNOTT ANS with automatic adjustment | Wheel Rims: Steel rims, silver with wheel covers | Windows: Hinged window, can be opened, double-glazed and tinted, Front window with fully integrated pleated blackout blind and insect screen, Combi Cassette with pleated blind and fly screen, for all windows (excluding washroom) | Body: Rooflight DOMETIC SEITZ, Midi-Heki 700 x 500 mm, with pleated blind and fly screen in living area, Rooflight DOMETIC SEITZ, Mini-Heki 400 x 400 mm, with pleated blind and fly screen in sleeping area, Winter vents for seating area, lockers and beds, One-piece entrance door, extra wide with triple-point locking, window, waste bin, compartments and pleated insect screen in door frame, design dependent on model, Grab handle, Entrance step, Integrated awning rail, Awning rail rain deflector with water drainage, front / rear, Wheel arches, thermally insulated, Wheel arch guard with rubber lip for draught skirt, LED awning light, Gas locker,

Furniture finish: Cape Town / White | Upholstery combinations: Neo | Kitchen: Refrigerator DOMETIC, 133 litres, 10 series, including 12-litre freezer compartment, double-hinged, absorption technology, Stainless steel hob / sink combination with 3-burner hob, electric ignition and split glass cover, Spice racks, Drawers, generously sized, fully extendable, with soft-close and push lock mechanisms, Cutlery insert, Towel rail, Kitchen splashback with fully integrated blackout blind and insect screen, kitchen light, 230 V power sockets and USB charging socket | Sleeping area: Double bed, Sprung mattresses on single, double and queen-size beds, Bed lift for slatted frame with gas spring for double beds and queen-size beds | Washroom: Compact washroom with integrated shower tray and external washbasin, Cassette toilet THETFORD, Hinged window with frosted glass look, can be opened | Water / gas / electricity: Waste water tank, 23.5 litres, rollable, Fresh water tank, 47 litres, Submersible pump, Gas regulator with over-pressure protection (DIN EN 12 864) and hose line, Gas control taps in kitchen unit, Control panel for lighting system and tank display, Light switch for children, Electronically

accommodates 2 x 11 kg bottles, Locker door MAXI, THETFORD with central locking, 1,000 x 300 mm, lockable | Living area: Hook-on table, Metal lift table, Wardrobe with interior light, Wall units with plenty of storage space and soft-close doors, Compartment under seating area, TV unit with illuminated cabinet |

controlled 12 V / 350 VA power supply, Ground fault circuit breaker, Exterior awning socket, including 230 V output, satellite / TV connection, Antenna socket with co-axial cable in living area, Passenger vehicle connector JAEGER, 13-pole, Smoke alarm | LED lighting: Ambient lighting, design dependent on model, Corner shelves with lighting in seating area, design dependent on model, Reading lights that change colour, can be dimmed in three stages, in seating area | Smart Home: HOBBY CONNECT, controls for on-board technology via Hobby control panel and Bluetooth using app | Heating / air conditioning: Heating system TRUMA Combi 6 including 10-litre hot water supply system and frost monitor valve |

## OPTIONAL EXTRAS

---

### Chassis / Safety

---

Load indicator on the jockey wheel

---

Spare wheel with holder, underfloor mounting

---

Stabilisation system KNOTT ETS Plus

---

Hitch lock anti-theft device KNOTT "KS 25"

---

### Increase / decrease in load capacity

---

Decrease in load capacity to 1,800 kg, without any technical modifications

---

Increase in load capacity to 2,000 kg, with technical modification for tandem-axle vehicles, from model 620

---

Increase in load capacity to 2,200 kg, with technical modification for tandem-axle vehicles, from model 620

---

### Wheel Rims

---

Alloy rims silver, from model 620

---

Alloy rims black, polished, from model 620

---

### Body

---

Rear lights with dynamic indicator

---

Roof awning THULE OMNISTOR 6300, width 450 cm, pull-out depth 250 cm

---

Bicycle rack THULE, for drawbar, 2 bicycles, loading capacity 60 kg

---

Bicycle rack THULE, for rear, 2 bicycles, loading capacity 40 kg

---

### Living area

---

Single-post lift table with innovative, one-handed operation

---

Carpet in the living area, removable

---

### Upholstery combinations

---

Neo including decorative set

---

Pico

---

## Kitchen

---

Oven THETFORD with electric ignition, grill and interior light, 36 litres

---

Extractor hood DOMETIC including Hobby 10-stage speed control

---

Microwave, 20 litres and extractor hood DOMETIC

---

## Sleeping area

---

Cold foam mattress, with comfortzones and slatted bed base for double bed and queen-size bed

---

Bedspread

---

## Washroom

---

Clothes rail in the shower

---

Shower fitting and shower curtain for washroom with external washbasin

---

Blackout blind including insect screen for washroom

---

## Water / gas / electricity

---

Gas pressure regulator TRUMA DuoControl including automatic changeover, crash sensor and gas filter

---

Smart Trailer System (vehicle levelling and fuel level indicator via E-Trailer app)

---

City water connection

---

External gas socket

---

Water pump with additional switch

---

Autonomy package including charge controller with booster, battery (AGM, 95 Ah), battery sensor and battery case

---

Autonomy package with lithium battery SUPER B Epsilon, 12 V / 150 Ah

---

Pre wiring for autonomy package including charge controller with booster, battery sensor and battery case

---

Carbon monoxide detector

---

Dual USB charging socket

---

## Heating / air conditioning

---

Heating system TRUMA Combi 6 E, instead of Combi 6

---

Underfloor heating from model 545

---

Hot water heater ALDE COMPACT 3020 HE including CI-BUS

---

Hot water underfloor heating for hot water heater ALDE

---

Roof-mounted air conditioning unit DOMETIC FreshJet including CI-BUS, with heating function, without lighting,

---

2.2 KW

---

Pre wiring for roof-mounted air conditioning unit

---

## Multimedia

---

Articulated TV bracket including required connections, without video cables (Cinch)

---