

EXCELLENT EDITION 650 KMFE

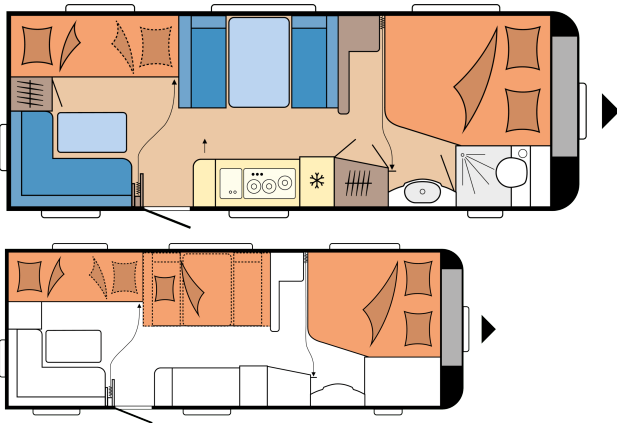

FLOORPLAN



| | |
|--------------------------------------|----------|
| Overall length | 8.325 mm |
| Total width | 2.500 mm |
| Technically permissible gross weight | 1.900 kg |

from: 0 £

Note: The vehicles shown are model examples. Illustrations may vary.

TECHNICAL DATA

| | |
|---|------------------|
| Model | 650 KMFe |
| Number of axles | 2 |
| Tyre size | 155 / 80 R 13 XL |
| Overall length | 8.325 mm |
| Body length | 7.156 mm |
| Overall width / Inside width | 2.500 / 2.367 mm |
| Overall height / Interior headroom | 2.629 / 1.950 mm |
| Maximum technically permissible laden mass | 1.900 kg |
| Mass in running order | 1.668 kg |
| Payload | 232 kg |
| Technically possible increase in load capacity to | 2.200 kg |
| Payload after maximum increase in load capacity | 524 kg |
| Body wall thickness (floor / roof / wall) | 39 / 31 / 31 mm |
| Awning circumference | 10.920 mm |

| | |
|---|--------------------------|
| Beading (straight edge) | 5.172 |
| Number of berths (adults / children) | 3 / 2 |
| Bed size, double bed (length x width) | 1.950 x 1.570 / 1.280 mm |
| Bed size, children's beds (length x width) | 2 x 1.850 x 700 mm |
| Bed size, seating area bed conversion (length x width) | 2.100 x 1.130 mm |
| Autonomy package | Front centre |
| Roof-mounted air conditioning unit | Front |
| TV bracket | Seating area |
| Fresh water tank; city water connection, optional | Rear right |
| External gas socket | Rear right |
| Exterior awning socket | Front right |
| Locker door MAXI, THETFORD with central locking, 1,000 x 300 mm, lockable | Front left |
| Number of 230 V power sockets (single / double) | 5 / 2 |

HOBBYKOMPLETT

Chassis / Safety: Jockey wheel, Drawbar cover, One-key locking system, Integrated 3rd brake light, Rear fog light, Wheel shock absorbers, Heavy-duty supports, Licensed for up to 100 kph, Stabiliser hitch KNOTT, Overrun brake KNOTT ANS with automatic adjustment | Wheel Rims: Steel rims, silver with wheel covers | Windows: Hinged window, can be opened, double-glazed and tinted, Front window with fully integrated pleated blackout blind and insect screen, Combi Cassette with pleated blind and fly screen, for all windows (excluding washroom) | Body: Rooflight DOMETIC SEITZ, Midi-Heki 700 x 500 mm, with pleated blind and fly screen in living area, Rooflight DOMETIC SEITZ, Mini-Heki 400 x 400 mm, with pleated blind and fly screen in sleeping area, Winter vents for seating area, lockers and beds, One-piece entrance door, extra wide with triple-point locking, window, waste bin, compartments and pleated insect screen in door frame, design dependent on model, Grab handle, Entrance step, Integrated awning rail, Awning rail rain deflector with water drainage, front / rear, Wheel arches, thermally insulated, Wheel arch guard with rubber lip for draught skirt, LED awning light, Gas locker, accommodates 2 x 11 kg bottles, Locker door MAXI, THETFORD

Upholstery combinations: Neo | Kitchen: Refrigerator DOMETIC, 133 litres, 10 series, including 12-litre freezer compartment, double-hinged, absorption technology, Stainless steel hob / sink combination with 3-burner hob, electric ignition and split glass cover, Spice racks, Drawers, generously sized, fully extendable, with soft-close and push lock mechanisms, Cutlery insert, Towel rail, Kitchen splashback with fully integrated blackout blind and insect screen, kitchen light, 230 V power sockets and USB charging socket, Kitchen light and separate power sockets | Sleeping area: Double bed, Children's bed, 2 tiers with guard and ladder, Sprung mattresses on single, double and queen-size beds, Bed lift for slatted frame with gas spring for double beds and queen-size beds | Washroom: Compact washroom with integrated shower tray and external washbasin, Cassette toilet THETFORD, Hinged window with frosted glass look, can be opened | Water / gas / electricity: Waste water tank, 23.5 litres, rollable, Fresh water tank, 47 litres, Submersible pump, Gas regulator with over-pressure protection (DIN EN 12 864) and hose line, Gas control taps in kitchen unit, Control panel for lighting system and tank display, Light switch for children, Electronically controlled 12 V /

with central locking, 1,000 x 300 mm, lockable | Living area: Metal lift table, Single-post lift table with innovative, one-handed operation, Wardrobe with interior light, Wall units with plenty of storage space and soft-close doors, Compartment under seating area | Furniture finish: Cape Town / White |

350 VA power supply, Ground fault circuit breaker, Exterior awning socket, including 230 V output, satellite / TV connection, Antenna socket with co-axial cable in living area, Passenger vehicle connector JAEGER, 13-pole, Smoke alarm | LED lighting: Ambient lighting, design dependent on model, Corner light in children's seating area | Smart Home: HOBBY CONNECT, controls for on-board technology via Hobby control panel and Bluetooth using app | Heating / air conditioning: Heating system TRUMA Combi 6 including 10-litre hot water supply system and frost monitor valve |

OPTIONAL EXTRAS

Chassis / Safety

Load indicator on the jockey wheel

Stabilisation system KNOTT ETS Plus

Hitch lock anti-theft device KNOTT "KS 25"

Increase / decrease in load capacity

Increase in load capacity to 2,000 kg, with technical modification for tandem-axle vehicles, from model 620

Increase in load capacity to 2,200 kg, with technical modification for tandem-axle vehicles, from model 620

Wheel Rims

Alloy rims silver, from model 620

Alloy rims black, polished, from model 620

Body

Rear lights with dynamic indicator

Roof awning THULE OMNISTOR 6300, width 450 cm, pull-out depth 250 cm

Bicycle rack THULE, for drawbar, 2 bicycles, loading capacity 60 kg

Bicycle rack THULE, for rear, 2 bicycles, loading capacity 40 kg

Living area

Carpet in the living area, removable

Upholstery combinations

Neo including decorative set

Pico

Kitchen

Oven THETFORD with electric ignition, grill and interior light, 36 litres

Extractor hood DOMETIC including Hobby 10-stage speed control

Microwave, 20 litres and extractor hood DOMETIC

Sleeping area

Children's bed, 3 tiers including 3rd window, with guard and ladder

Cold foam mattress, with comfortzones and slatted bed base for double bed and queen-size bed

Bedspread

Washroom

Clothes rail in the shower

Shower fitting and shower curtain for washroom with external washbasin

Blackout blind including insect screen for washroom

Water / gas / electricity

Gas pressure regulator TRUMA DuoControl including automatic changeover, crash sensor and gas filter

Smart Trailer System (vehicle levelling and fuel level indicator via E-Trailer app)

City water connection

External gas socket

Water pump with additional switch

Autonomy package including charge controller with booster, battery (AGM, 95 Ah), battery sensor and battery case

Autonomy package with lithium battery SUPER B Epsilon, 12 V / 150 Ah

Pre wiring for autonomy package including charge controller with booster, battery sensor and battery case

Carbon monoxide detector

Dual USB charging socket and children's bed lights including USB charging socket

Heating / air conditioning

Heating system TRUMA Combi 6 E, instead of Combi 6

Underfloor heating from model 545

Hot water heater ALDE COMPACT 3020 HE including CI-BUS

Hot water underfloor heating for hot water heater ALDE

Roof-mounted air conditioning unit DOMETIC FreshJet including CI-BUS, with heating function, without lighting,

2.2 KW

Pre wiring for roof-mounted air conditioning unit

Multimedia

Articulated TV bracket including required connections, without video cables (Cinch)
