

# EXCELLENT EDITION 560 KMFE

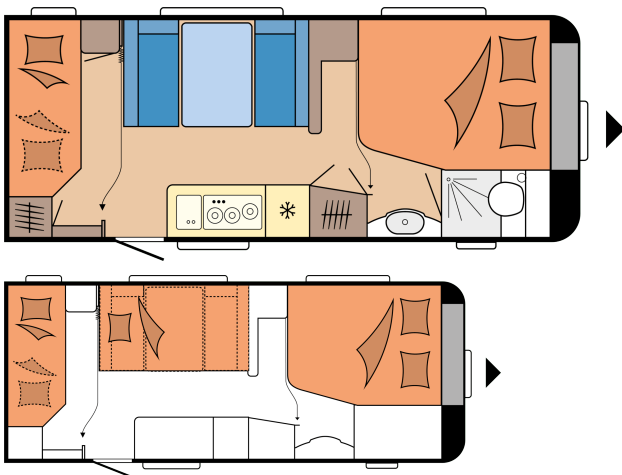

## FLOORPLAN



Overall length	7.514 mm
Total width	2.500 mm
Technically permissible gross weight	1.700 kg

from: **0 £**

Note: The vehicles shown are model examples. Illustrations may vary.

## TECHNICAL DATA

Model	560 KMFe
Number of axles	1
Tyre size	195 / 70 R 15 C
Overall length	7.514 mm
Body length	6.344 mm
Overall width / Inside width	2.500 / 2.367 mm
Overall height / Interior headroom	2.641 / 1.950 mm
Maximum technically permissible laden mass	1.700 kg
Mass in running order	1.468 kg
Payload	232 kg
Technically possible increase in load capacity to	2.000 kg
Payload after maximum increase in load capacity	516 kg
Body wall thickness (floor / roof / wall)	39 / 31 / 31 mm
Awning circumference	10.120 mm

Beading (straight edge)	4.360
Number of berths (adults / children)	3 / 2
Bed size, double bed (length x width)	1.950 x 1.570 / 1.280 mm
Bed size, children's beds (length x width)	1.840 x 730; 1.840 x 700 mm
Bed size, seating area bed conversion (length x width)	1.976 x 1.130 mm
Autonomy package	Front centre
Roof-mounted air conditioning unit	Centre
TV bracket	Seating area
Fresh water tank; city water connection, optional	Front left
External gas socket	Centre right
Exterior awning socket	Centre right
Locker door MAXI, THETFORD with central locking, 1.000 x 300 mm, lockable	Front left
Number of 230 V power sockets (single / double)	6 / 1

## HOBBYKOMPLETT

Chassis / Safety: Jockey wheel, Drawbar cover, One-key locking system, Integrated 3rd brake light, Rear fog light, Wheel shock absorbers, Tyre repair set, Heavy-duty supports, Load indicator on the jockey wheel, Licensed for up to 100 kph, Stabiliser hitch KNOTT, Overrun brake KNOTT ANS with automatic adjustment | Wheel Rims: Steel rims, silver with wheel covers | Windows: Hinged window, can be opened, double-glazed and tinted, Front window with fully integrated pleated blackout blind and insect screen, Combi Cassette with pleated blind and fly screen, for all windows (excluding washroom) | Body: Rooflight DOMETIC SEITZ, Midi-Heki 700 x 500 mm, with pleated blind and fly screen in living area, Rooflight DOMETIC SEITZ, Mini-Heki 400 x 400 mm, with pleated blind and fly screen in sleeping area, Rooflight DOMETIC SEITZ, Mini-Heki 400 x 400 mm, with pleated blind and fly screen in children's sleeping area, Winter vents for seating area, lockers and beds, One-piece entrance door, extra wide with triple-point locking, window, waste bin, compartments and pleated insect screen in door frame, design dependent on model, Grab handle, Entrance step, Integrated awning rail, Awning rail rain deflector with water drainage, front / rear, Wheel arches,

Furniture finish: Cape Town / White | Upholstery combinations: Neo | Kitchen: Refrigerator DOMETIC, 133 litres, 10 series, including 12-litre freezer compartment, double-hinged, absorption technology, Stainless steel hob / sink combination with 3-burner hob, electric ignition and split glass cover, Spice racks, Drawers, generously sized, fully extendable, with soft-close and push lock mechanisms, Cutlery insert, Towel rail, Kitchen splashback with fully integrated blackout blind and insect screen, kitchen light, 230 V power sockets and USB charging socket, Kitchen light and separate power sockets | Sleeping area: Double bed, Children's bed, 2 tiers with guard and ladder, Lower children's bed foldable, colouring board on underside, Sprung mattresses on single, double and queen-size beds, Bed lift for slatted frame with gas spring for double beds and queen-size beds | Washroom: Compact washroom with integrated shower tray and external washbasin, Cassette toilet THETFORD, Hinged window with frosted glass look, can be opened | Water / gas / electricity: Waste water tank, 23.5 litres, rollable, Fresh water tank, 47 litres, Submersible pump, Gas regulator with over-pressure protection (DIN EN 12 864) and hose line, Gas control

thermally insulated, Wheel arch guard with rubber lip for draught skirt, LED awning light, Gas locker, accommodates 2 x 11 kg bottles, Locker door MAXI, THETFORD with central locking, 1,000 x 300 mm, lockable | Living area: Single-post lift table with innovative, one-handed operation, Wardrobe with interior light, Wall units with plenty of storage space and soft-close doors, Compartment under seating area |

taps in kitchen unit, Control panel for lighting system and tank display, Light switch for children, Electronically controlled 12 V / 350 VA power supply, Ground fault circuit breaker, Exterior awning socket, including 230 V output, satellite / TV connection, Antenna socket with co-axial cable in living area, Passenger vehicle connector JAEGER, 13-pole, Smoke alarm | LED lighting: Ambient lighting, design dependent on model | Smart Home: HOBBY CONNECT, controls for on-board technology via Hobby control panel and Bluetooth using app | Heating / air conditioning: Heating system TRUMA Combi 6 including 10-litre hot water supply system and frost monitor valve |

## OPTIONAL EXTRAS

---

### Chassis / Safety

---

Spare wheel with holder, instead of tyre repair set, underfloor mounting

---

Stabilisation system KNOTT ETS Plus

---

Hitch lock anti-theft device KNOTT "KS 25"

---

### Increase / decrease in load capacity

---

Increase in load capacity to 1,800 kg, without any technical modifications

---

Increase in load capacity to 2,000 kg, with technical modification for single-axle vehicles, including silver alloy rims

---

Increase in load capacity to 2,000 kg, with technical modification for single-axle vehicles, including black alloy rims

---

### Wheel Rims

---

Alloy rims silver, up to model 595

---

### Body

---

Rear lights with dynamic indicator

---

Roof awning THULE OMNISTOR 6300, width 400 cm, pull-out depth 250 cm

---

Bicycle rack THULE, for drawbar, 2 bicycles, loading capacity 60 kg

---

Bicycle rack THULE, for rear, 2 bicycles, loading capacity 40 kg

---

Garage under bunk bed (not in conjunction with hot water heater ALDE, colouring board under children's bed removed)

---

### Living area

---

Carpet in the living area, removable

---

### Upholstery combinations

---

Neo including decorative set

---

Pico

---

## Kitchen

Oven THETFORD with electric ignition, grill and interior light, 36 litres

Extractor hood DOMETIC including Hobby 10-stage speed control

Microwave, 20 litres and extractor hood DOMETIC

## Sleeping area

Children's bed, 3 tiers with guard and ladder

Cold foam mattress, with comfortzones and slatted bed base for double bed and queen-size bed

Bedspread

## Washroom

Clothes rail in the shower

Shower fitting and shower curtain for washroom with external washbasin

Blackout blind including insect screen for washroom

## Water / gas / electricity

Gas pressure regulator TRUMA DuoControl including automatic changeover, crash sensor and gas filter

Smart Trailer System (vehicle levelling and fuel level indicator via E-Trailer app)

City water connection

External gas socket

Water pump with additional switch

Autonomy package including charge controller with booster, battery (AGM, 95 Ah), battery sensor and battery case

Autonomy package with lithium battery SUPER B Epsilon, 12 V / 150 Ah

Pre wiring for autonomy package including charge controller with booster, battery sensor and battery case

Carbon monoxide detector

Dual USB charging socket and children's bed lights including USB charging socket

## Heating / air conditioning

Heating system TRUMA Combi 6 E, instead of Combi 6

Underfloor heating from model 545

Hot water heater ALDE COMPACT 3020 HE including CI-BUS

Roof-mounted air conditioning unit DOMETIC FreshJet including CI-BUS, with heating function, without lighting,

2.2 KW

Pre wiring for roof-mounted air conditioning unit

## Multimedia

Articulated TV bracket including required connections, without video cables (Cinch)