

# MAXIA 660 WQM

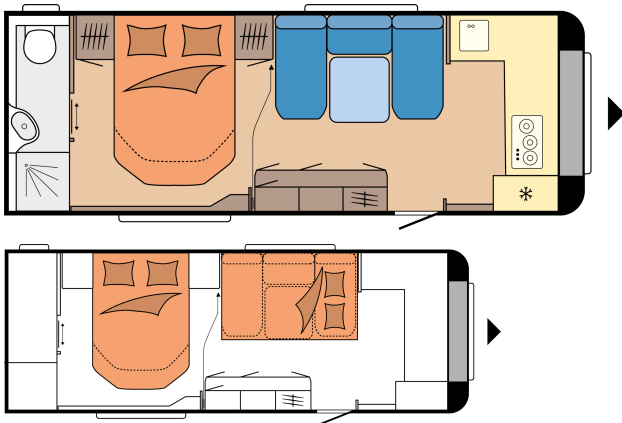

## FLOORPLAN



Overall length	8.325 mm
Total width	2.500 mm
Technically permissible gross weight	2.000 kg

from: **0 £**

Note: The vehicles shown are model examples. Illustrations may vary.

## TECHNICAL DATA

Model	660 WQM	Awning circumference	10.920 mm
Number of axles	2	Beading (straight edge)	5.172
Tyre size	165 R 13 C	Number of berths (adults / children)	4
Overall length	8.325 mm	Bed size, queen-size bed (length x width)	1.990 x 1.395 mm
Body length	7.156 mm	Bed size, seating area bed conversion (length x width)	2.000 x 1.200 mm
Overall width / Inside width	2.500 / 2.367 mm	Autonomy package	Centre left
Overall height / Interior headroom	2.637 / 1.950 mm	Roof-mounted air conditioning unit	Centre
Maximum technically permissible laden mass	2.000 kg	TV bracket	Sideboard
Mass in running order	1.710 kg	Fresh water tank; city water connection, optional	Rear left
Payload	290 kg	External gas socket	Centre right
Technically possible increase in load capacity to	2.200 kg	Exterior awning socket	Centre right
Payload after maximum increase in load capacity	490 kg	Locker door, THETFORD with central locking, 752 x 310 mm, lockable	Centre left
Body wall thickness (floor / roof / wall)	39 / 31 / 31 mm	Number of 230 V power sockets (single / double)	8 / 1

## HOBBYKOMPLETT

Chassis / Safety: Jockey wheel, Drawbar cover, One-key locking system, Integrated 3rd brake light, Rear fog light, Wheel shock absorbers, Heavy-duty supports, Licensed for up to 100 kph, Stabiliser hitch KNOTT, Overrun brake KNOTT ANS with automatic adjustment | Wheel Rims: Alloy rims black, polished, from model 620 | Windows: Hinged window, can be opened, double-glazed and tinted, Panoramic front window with fully integrated pleated blind and fly screen, Panoramic roof vent "HOBBY TOP", can be opened, double-glazed and tinted, Combi Cassette with pleated blind and fly screen, for all windows (excluding washroom) | Body: Rooflight DOMETIC SEITZ, Midi-Heki 700 x 500 mm, with pleated blind and fly screen in living area, Rooflight DOMETIC SEITZ, Mini-Heki 400 x 400 mm, with pleated blind and fly screen in sleeping area, Winter vents for seating area, lockers and beds, One-piece entrance door, extra wide with triple-point locking, window, waste bin, compartments and pleated insect screen in door frame, design dependent on model, Grab handle, Entrance step, Integrated awning rail, Awning rail rain deflector with water drainage, front / rear, Wheel arches, thermally insulated, Wheel arch guard with rubber lip for draught skirt, LED awning light, Gas locker, accommodates 2 x 11 kg bottles, Locker

Living area: TV unit with illuminated cabinet, Kitchen partition with industrial design | Furniture finish: Graphitegrey / Walnut | Upholstery combinations: Pico | Kitchen: Refrigerator DOMETIC, 157 litres, 10 series, including 18-litre freezer compartment, double-hinged, compressor technology, Designer 3-burner "Gas-on-Glass" hob with electric ignition, Stainless steel sink and designer sink fittings, Corner base cabinet with swivel pull-out, Spice racks, Drawers, generously sized, fully extendable, with soft-close and push lock mechanisms, Cutlery insert, Kitchen light and separate power sockets | Sleeping area: Queen-size bed, Bed lift for slatted frame with gas spring for double beds and queen-size beds, Cold foam mattress, with comfortzones and slatted bed base for double bed and queen-size bed | Washroom: Rear washroom with separate shower cubicle, design dependent on model, Swivel toilet THETFORD, Hinged window with frosted glass look, can be opened | Water / gas / electricity: Waste water tank, 23.5 litres, rollable, Fresh water tank, 47 litres, Submersible pump, Gas regulator with over-pressure protection (DIN EN 12 864) and hose line, Gas control taps in kitchen unit, Control panel for lighting system and tank display, Light switch for children, Ground fault circuit breaker, Exterior awning socket, including 230 V output,

door, THETFORD with central locking, 752 x 310 mm, lockable | Living area: Single-post lift table with innovative, one-handed operation, Heated coat rack in entrance area, Wardrobe with interior light, Wall units with plenty of storage space and soft-close doors, Compartment under seating area |

satellite / TV connection, Antenna socket with co-axial cable in living area, Passenger vehicle connector JAEGER, 13-pole, Smoke alarm, Dual USB charging socket | LED lighting: Ambient lighting, design dependent on model | Smart Home: HOBBY CONNECT, controls for on-board technology via Hobby control panel and Bluetooth using app | Heating / air conditioning: Heating system TRUMA Combi 6 including 10-litre hot water supply system and frost monitor valve |

## OPTIONAL EXTRAS

### Chassis / Safety

Load indicator on the jockey wheel	0,6 kg
Stabilisation system KNOTT ETS Plus	5,7 kg
Hitch lock anti-theft device KNOTT "KS 25"	0,3 kg

### Increase / decrease in load capacity

Decrease in load capacity to 1,900 kg, without any technical modifications	
Increase in load capacity to 2,000 kg, with technical modification for tandem-axle vehicles, from model 620	8 kg
Increase in load capacity to 2,200 kg, with technical modification for tandem-axle vehicles, from model 620	8 kg

### Body

Rear lights with dynamic indicator	1 kg
Roof awning THULE OMNISTOR 6300, width 450 cm, pull-out depth 250 cm	35 kg
Bicycle rack THULE, for drawbar, 2 bicycles, loading capacity 60 kg	10 kg
Bicycle rack THULE, for rear, 2 bicycles, loading capacity 40 kg	7,5 kg

### Living area

Carpet in the living area, removable	10 kg
--------------------------------------	-------

### Kitchen

Oven THETFORD with electric ignition, grill and interior light, 36 litres	15 kg
---	-------

### Water / gas / electricity

Waste water tank, 50 litres, insulated and heated	
Gas pressure regulator TRUMA DuoControl including automatic changeover, crash sensor and gas filter	2,2 kg
Smart Trailer System (vehicle levelling and fuel level indicator via E-Trailer app)	0,8 kg
City water connection	0,5 kg
External gas socket	1,5 kg
Water pump with additional switch	0,4 kg
Autonomy package including charge controller with booster, battery (AGM, 95 Ah), battery sensor and battery case	29 kg

Autonomy package with lithium battery SUPER B Epsilon, 12 V / 150 Ah	19,1 kg
Pre wiring for autonomy package including charge controller with booster, battery sensor and battery case	2,8 kg
Carbon monoxide detector	0,5 kg

### Heating / air conditioning

Heating system TRUMA Combi 6 E, instead of Combi 6	1,1 kg
Underfloor heating from model 545	6 kg
Hot water heater ALDE COMPACT 3020 HE including CI-BUS	41,5 kg
Hot water underfloor heating for hot water heater ALDE	35 kg
Roof-mounted air conditioning unit DOMETIC FreshJet including CI-BUS, with heating function, without lighting, 2.2 KW	32 kg
Pre wiring for roof-mounted air conditioning unit	1,5 kg

### Multimedia

Articulated TV bracket including required connections, without video cables (Cinch)	2 kg
---	------