

MAXIA 595 KML

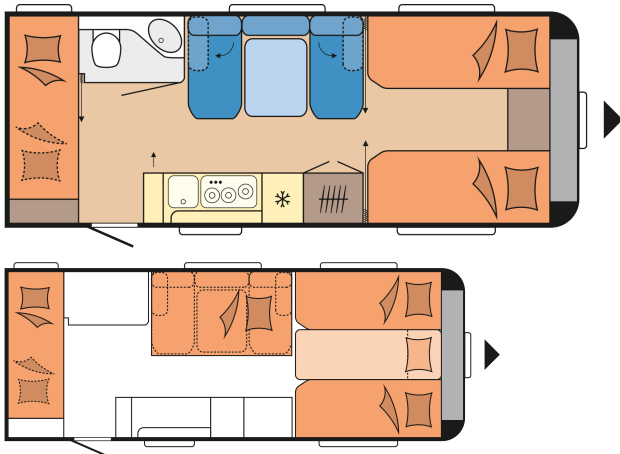

FLOORPLAN



Overall length	7.976 mm
Total width	2.500 mm
Technically permissible gross weight	1.800 kg

from: **0 £**

Note: The vehicles shown are model examples. Illustrations may vary.

TECHNICAL DATA

Model	595 KML	Beading (straight edge)	4.822
Number of axles	1	Number of berths (adults / children)	3 / 2
Tyre size	195 / 70 R 15 C	Bed size, single beds (length x width)	2 x 2.000 x 800 mm
Overall length	7.976 mm	Bed size, children's beds (length x width)	2.000 x 760; 2.000 x 730 mm
Body length	6.806 mm	Bed size, seating area bed conversion (length x width)	2.233 x 1.400 / 1.300 mm
Overall width / Inside width	2.500 / 2.367 mm	Autonomy package	Front right
Overall height / Interior headroom	2.641 / 1.950 mm	Roof-mounted air conditioning unit	Centre
Maximum technically permissible laden mass	1.800 kg	TV bracket	Seating area / washroom
Mass in running order	1.589 kg	Fresh water tank; city water connection, optional	Centre left
Payload	211 kg	External gas socket	Centre right
Technically possible increase in load capacity to	2.000 kg	Exterior awning socket	Centre right
Payload after maximum increase in load capacity	395 kg	Locker door MAXI, THETFORD with central locking, 1,000 x 300 mm, lockable	Bug rechts + links
Body wall thickness (floor / roof / wall)	39 / 31 / 31 mm	Number of 230 V power sockets (single / double)	8 / 1
Awning circumference	10.592 mm		

HOBBYKOMPLETT

Chassis / Safety: Jockey wheel, Drawbar cover, One-key locking system, Integrated 3rd brake light, Rear fog light, Wheel shock absorbers, Tyre repair set, Heavy-duty supports, Load indicator on the jockey wheel, Licensed for up to 100 kph, Stabiliser hitch KNOTT, Overrun brake KNOTT ANS with automatic adjustment | Wheel Rims: Steel rims, silver with wheel covers, Alloy rims black, polished, up to model 595 | Windows: Hinged window, can be opened, double-glazed and tinted, Front window with fully integrated pleated blackout blind and insect screen, Combi Cassette with pleated blind and fly screen, for all windows (excluding washroom) | Body: Rooflight DOMETIC SEITZ, Midi-Heki 700 x 500 mm, with pleated blind and fly screen in living area, Rooflight DOMETIC SEITZ, Mini-Heki 400 x 400 mm, with pleated blind and fly screen in sleeping area, Rooflight DOMETIC SEITZ, Mini-Heki 400 x 400 mm, with pleated blind and fly screen in children's sleeping area, Rooflight DOMETIC SEITZ, Micro-Heki 280 x 280 mm, with pleated blind and fly screen in washroom, Winter vents for seating area, lockers and beds, One-piece entrance door, extra wide with triple-point locking, window, waste bin, compartments and pleated insect screen in door frame, design

Living area: Set of Hobby glasses | Furniture finish: Graphitegrey / Walnut | Upholstery combinations: Pico | Kitchen: Refrigerator DOMETIC, 133 litres, 10 series, including 12-litre freezer compartment, double-hinged, absorption technology, Stainless steel hob / sink combination with 3-burner hob, electric ignition and split glass cover, Spice racks, Drawers, generously sized, fully extendable, with soft-close and push lock mechanisms, Cutlery insert, Kitchen splashback with fully integrated blackout blind and insect screen, kitchen light, 230 V power sockets and USB charging socket, Kitchen light and separate power sockets | Sleeping area: Single beds, Children's bed area for two berths, including a ladder and guard, a seating area and/or storage space, flexible, Bed lift for slatted frame on single beds, mechanical, Cold foam mattresses, with comfortzones and slatted bed base for single beds, Storage baskets, set of four, for shelves in the flexible children's bed area | Washroom: Compact washroom with washbasin and toilet, design dependent on model, Swivel toilet THETFORD | Water / gas / electricity: Waste water tank, 23.5 litres, rollable, Fresh water tank, 47 litres, Submersible pump, Gas regulator with over-pressure protection (DIN EN 12 864) and

dependent on model, Grab handle, Entrance step, Integrated awning rail, Awning rail rain deflector with water drainage, front / rear, Wheel arches, thermally insulated, Wheel arch guard with rubber lip for draught skirt, LED awning light, Gas locker, accommodates 2 x 11 kg bottles, Locker door MAXI, THETFORD with central locking, 1,000 x 300 mm, lockable | Living area: Wardrobe with interior light, Wall units with plenty of storage space and soft-close doors, Compartment under seating area |

hose line, Gas control taps in kitchen unit, Control panel for lighting system and tank display, Light switch for children, Electronically controlled 12 V / 350 VA power supply, Ground fault circuit breaker, Exterior awning socket, including 230 V output, satellite / TV connection, Antenna socket with co-axial cable in living area, Passenger vehicle connector JAEGER, 13-pole, Smoke alarm, Dual USB charging socket | LED lighting: Ambient lighting, design dependent on model, Children's bed lights, dimmable with a night light and A/C USB ports | Smart Home: HOBBY CONNECT, controls for on-board technology via Hobby control panel and Bluetooth using app | Heating / air conditioning: Heating system TRUMA Combi 6 including 10-litre hot water supply system and frost monitor valve, Boiler TRUMA for hot water supply |

OPTIONAL EXTRAS

Chassis / Safety

Spare wheel with holder, instead of tyre repair set, underfloor mounting

Stabilisation system KNOTT ETS Plus

Hitch lock anti-theft device KNOTT "KS 25"

Increase / decrease in load capacity

Increase in load capacity to 2,000 kg, with technical modification for single-axle vehicles

Body

Rear lights with dynamic indicator

Roof awning THULE OMNISTOR 6300, width 450 cm, pull-out depth 250 cm

Bicycle rack THULE, for drawbar, 2 bicycles, loading capacity 60 kg

Bicycle rack THULE, for rear, 2 bicycles, loading capacity 40 kg

Living area

Carpet in the living area, removable

Kitchen

Oven THETFORD with electric ignition, grill and interior light, 36 litres

Sleeping area

Children's bed, third bed for a flexible children's bed area, middle position

Water / gas / electricity

Gas pressure regulator TRUMA DuoControl including automatic changeover, crash sensor and gas filter

Smart Trailer System (vehicle levelling and fuel level indicator via E-Trailer app)

City water connection

External gas socket

Water pump with additional switch

Autonomy package including charge controller with booster, battery (AGM, 95 Ah), battery sensor and battery case

Autonomy package with lithium battery SUPER B Epsilon, 12 V / 150 Ah

Pre wiring for autonomy package including charge controller with booster, battery sensor and battery case

Carbon monoxide detector

Heating / air conditioning

Heating system TRUMA Combi 6 E, instead of Combi 6

Underfloor heating from model 545

Hot water heater ALDE COMPACT 3020 HE including CI-BUS

Hot water underfloor heating for hot water heater ALDE

Roof-mounted air conditioning unit DOMETIC FreshJet including CI-BUS, with heating function, without lighting,

2.2 KW

Pre wiring for roof-mounted air conditioning unit

Multimedia

Articulated TV bracket including required connections, without video cables (Cinch)
